



BATHWARE
Collection

INDEX

- 04 ONE PIECE CLOSET
- 09 WALL HUNG CLOSET
- 11 TABLE TOP BASIN
- 14 WASH BASIN
- 16 WASH BASIN PEDESTAL
- 17 WASH BASIN HALF PEDESTAL
- 17 ONE PIECE HALF BASIN
- 18 WATER CLOSET
- 19 TWO PIECE CLOSET
- 20 PAN
- 22 URINAL



Code - 1001

Size : 650x370x750mm

S-Trap | P-Trap (9")



Code - 1002
Size : 640x360x740mm
Syphonic (9", 12")



Code - 1005
Size : 660x350x730mm
S-Trap | P-Trap (9")



Code - 1006
Size : 640x345x710mm
S-Trap | P-Trap (9", 12")



Code - 1007 Jet
Size : 710x380x685mm
S-Trap | P-Trap (9")



Code - 1008
Size : 660x360x760mm
S-Trap | P-Trap (9", 12")



Code - 1009
Size : 640x350x740mm
S-Trap | P-Trap (9", 12")



Code - 1010
Size : 650x345x695mm
S-Trap | P-Trap (9")



Code - 1011
Size : 665x345x785mm
Syphonic (9", 12")



Code - 1012
Size : 665x360x790mm
S-Trap | P-Trap (9", 12")



Code - 1014 Jet
Size : 720x377x730mm
S-Trap | P-Trap (9")



Code - 1017 Jet
Size : 670x360x725mm
S-Trap | P-Trap (9", 4")



Code - 1018
Size : 660x360x735mm
S-Trap | P-Trap (9")



Code - 1020
Size : 710x360x785mm
Syphonic 5D (9", 12")



Code - 1022
Size : 670x360x720mm
Syphonic (9", 12")



Code - 1023
Size : 640x355x765mm
Syphonic 6D (9", 12")



Code - 1024
Size : 680x370x715mm
S-Trap | P-Trap (9")



Code - 201
Size : 510x340x365mm



Code - 202
Size : 540x360x360mm



Code - 203
Size : 540x370x380mm



Code - 204
Size : 475x350x340mm



Code - 205
Size : 540x370x370mm
Rimless



Code - 206
Size : 490x350x365mm



Code - 207
Size : 510x345x390mm



Code - 208
Size : 550x370x350mm



Code - 209
Size : 475x360x370mm



Code - 101
Size : 470x360x130mm



Code - 102
Size : 400x400x130mm



Code - 103
Size : 440x375x130mm



Code - 104
Size : 400x400x110mm



Code - 105
Size : 385x325x140mm



Code - 106
Size : 350x390x135mm



Code - 108
Size : 440x390x145mm



Code - 109
Size : 500x385x125mm



Code - 110
Size : 430x350x185mm



Code - 111
Size : 495x385x130mm



Code - 112
Size : 365x368x155mm



Code - 113
Size : 450x325x125mm



Code - 114
Size : 705x355x140mm



Code - 115
Size : 705x355x140mm



Code - 501
Size : 500x400x150mm



Code - 601
Size : 400x500x210mm
450x300x210mm



Code - 602
Size : 400x500x190mm
450x300x150mm



Code - 603
Size : 400x500x190mm
450x300x190mm



Code - 501
Size : 16"x12"



Code - 502
Size : 16"x16"



Code - 503
Size : 18"x14"



Code - 504
Size : 18"x12"



Code - 505
Size : 18"x14"



Code - 506
Size : 18"x12"



Code - 507
Size : 18"x13"



Code - 509
Size : 14"x11"



Code - 510
Size : 14"x9"



Code - 511
Size : 12"x9"



Code - 512
Size : 18"x12"



Code - 513
Size : 18"x13"



Code - 514
Size : 14"x14"



Code - 515
Size : 16"x13"



Code - 516
Size : 19"x15"



Code - 301
Size : 20"x16"



Code - 302
Size : 22"x16"



Code - 303
Size : 20"x16"



Code - 301
Size : 400x500x710mm



Code - 302
Size : 400x550x720mm



Code - 303
Size : 400x500x720mm



Code - 304
Size : 450x350x710mm

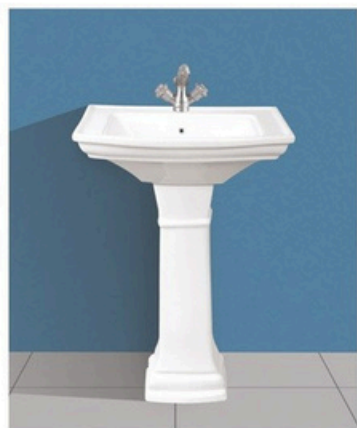

Code - 305
Size : 490x620x880mm



Code - 306
Size : 560x440x710mm



Code - 307
Size : 490x595x885mm



Code - 9001
Size : 550x410x475mm



Code - 9002
Size : 460x350x400mm

- ONE PIECE HALF BASIN



Code - 8001
Size : 465x420x300mm



Code - 8002
Size : 490x427x382mm



Code - 6001 (S) (P)
Size : 540x360x390mm



Code - 6002
Size : 540x380x395mm



Code - 6003
Size : 530x360x390mm



Code - 6004 (S) (P)
Size : 515x450x400mm



Code - 6005
Size : 530x335x400mm



Code - 6006
Size : 510x320x380mm



Code - 6007
Size : 550x340x400mm



Aqua - S



Aqua - P



Irani - S



Italian - P



Wall Hung Two Piece - Square



Wall Hung Two Piece - Round



Orissa Pan 20"



Orissa Havvy 20"



Orissa 23"



Orissa Havvy 23"



CT Pan



MD Pan



Istern Pan

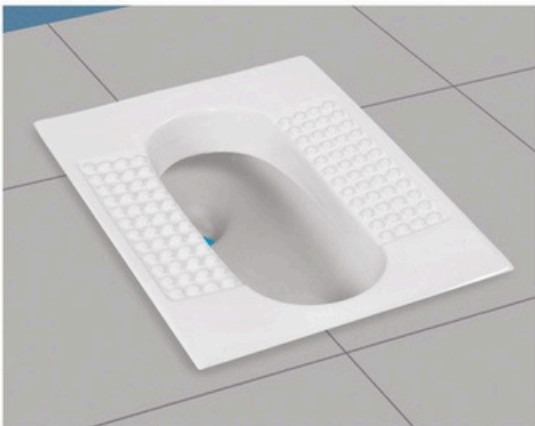

Aqua Prassure Pan

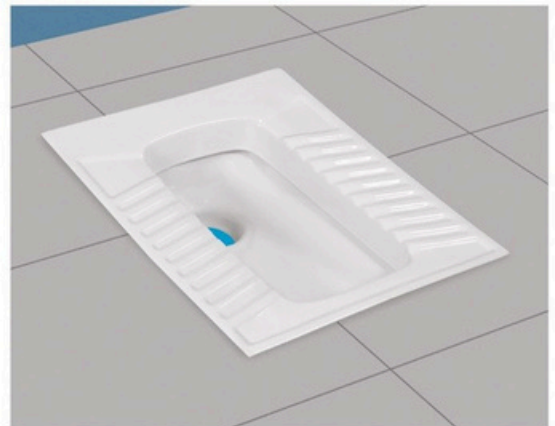

CT Pan - Square



Mini Half Stall Urinal
Size : 420x330x215mm



Half Stall Urinal
Size : 375x390x590mm



Flat Back Urinal
Size : 310x460x210mm



Ladies Urinal



Side Push Flush Tank



Top Push Flush Tank

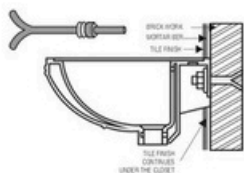

WALL HUNG BASIN

As per shown in the picture, the rag bolt must be grouted into the cement/concrete wall. The bolts must be fixed to the cement/concrete wall. Allow setting & checking than install it using nut and washer.

COUNTER WASHBASIN

At the beginning

1. A skilled or experienced person should install counter lavatories.
2. Avoid using adhesive with this product.
3. Check the waste area and supply tubing if required.
4. Do not open the lavatory from its protective carton until you are ready for installation.
5. Please follow all local building and plumbing codes.

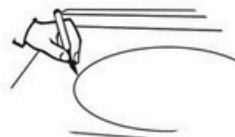

MATERIAL & TOOLS

Measure tape, Keyhole or saber saw, Hammer, Glasses, Rags or Paper toweling, Drill (1/2 dia, drill bit or larger), Pencil, sealant, sharp knife or scissors.

INSTALLATION OF LAVATORY

Please Note : Please install it in a way that future removal from underneath the counter top is possible without damaging the counter top.

1. Please check the desired location for clearance between the back splash, faucet, Fixture and cabinet.
2. Please cut the template.
3. Please carefully trace the template on the counter top directed.
4. Please mark the faucet hole centerline on the counter top.
5. Please drill a 1/2" pilot on the inside of the cut line.



For Wood Counter tops:

1. Mark and pre-drill the wood screw holes at the locations shown on the template.
2. Waterproof any exposed areas of wood.

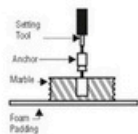

For Marble Counter tops:

1. Position the counter top upside down on foam padding to protect the surface. Mark and drill 3/6" holes 5/8" deep at the locations shown on the template.
2. Use a setting tool and hammer to secure the anchors.



For All Installations:

1. If the counter top has not been installed, install it at this time.
2. Drill the faucet holes according to the faucet installation instructions.
3. Install the faucet to the counter top according to the manufacture's instructions.
4. Install the drain to the lavatory according to the manufacture's instructions.



Mehul patel

Mo. +91 7984621911



www.jbmc ceramic.com